

QUICK-RELEASE NOZZLE ASSEMBLIES

- ◀ Uni-Spray Nozzles are injection molded from custom-blended polypropylene, a cost-effective material that is corrosion and heat-resistant and impervious to most chemicals.
- ◀ The tip design resists clogging and buildup due to its smooth shape and low coefficient of friction.
- ◀ A wide variety of Uni-Spray Clamp-On Nozzles are available to suit your application and are colour-coded for easy identification (see table below).
- ◀ All nozzles are available with a Single-Spring or an optional Double-Spring configuration for pressures over 60 psi (4.0 bar).
- ◀ All nozzles are available in three spigot sizes, to fit 9/16", 21/32" or 13/16" (14 mm, 17 mm and 19 mm) diameter holes in the riser.

Mark 1 Adjustable Nozzle Assembly

- ◀ Permits directional adjustment of the nozzle tip anywhere within a 45° included angle.
- ◀ Interchangeable Nozzle Tips are available in Full Cone, Hollow Cone or Flat Spray styles with various combinations of spray angle and flow rate.
- ◀ The Mark 1 is also available with a Threaded Ball Connection in 1/8", 1/4", 3/8" and 1/2" NPT or BSP, allowing the use of any threaded plastic, brass or steel nozzle.
- ◀ Refer to pages 4 and 5 for Assembly Details and Ordering Information, pages 11 and 14 for Tip Selection and page 15 for Replacement Parts.



Mark 2 Fixed Nozzle Adapter

- ◀ Offers female threaded connections in 1/8", 1/4", 3/8" and 1/2" NPT or 1/8" BSP threads, allowing the use of any threaded plastic, brass or steel nozzle.
- ◀ See pages 6 and 7 for Assembly Details and Ordering Information.



Available Sizes

The Mark 1 and Mark 2 Nozzle Assemblies are colour-coded for convenient identification, and are available to fit the following pipe sizes:

(Inch / mm)		Reg. Spigot (21/32")	Sm. Spigot (9/16")	Lg. Spigot (13/16")
1"	25 mm	Blue	Lt Blue	Lt Blue
1"	32 mm	Red	Pink	Pink
1 1/2"	40 mm	Purple	Mauve	Mauve
2"	50 mm	Green	Lime green	Lime Green



FEATURES

- Inexpensive
- Corrosion resistant
- Impervious to most chemicals
- Good heat resistance
- Injection-molded from custom-blended polypropylene
- Standard with Single Spring Clamp
- Optional Double Spring Clamps for pressures over 60 psi (4.0 bar)
- Available with threaded connection in 1/8", 1/4", 3/8" and 1/2" NPT or 1/8" BSP threads
- Nozzle bodies fit 21/32" diameter holes on the riser

Mark 2 Fixed Nozzle Adapter

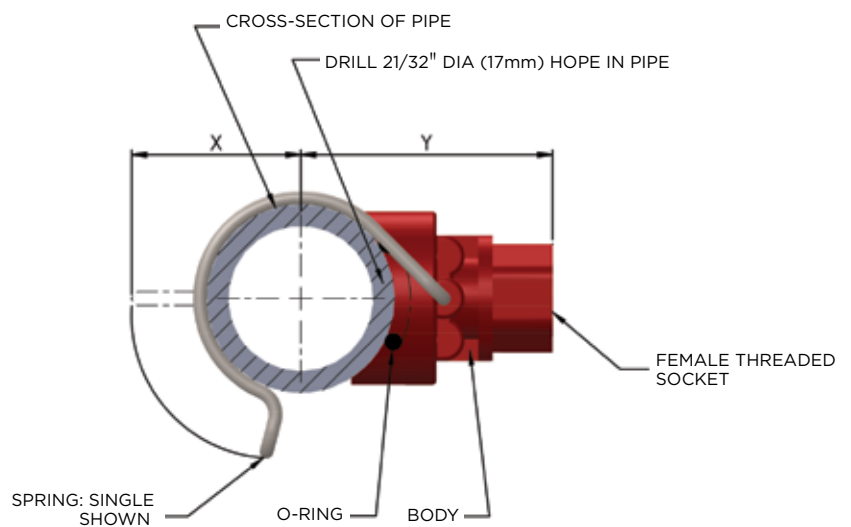

MAJOR DIMENSIONS

(inch / mm)	X	Y
1" Pipe	1.70	2.01
1 1/4" Pipe	1.89	2.21
1 1/2" Pipe	2.02	2.30
2" Pipe	2.25	2.54
<hr/>		
25 mm Pipe	43.2	51.1
32 mm Pipe	48.0	56.1
40 mm Pipe	51.3	58.4
50 mm Pipe	57.2	64.5

Also available with Double Springs for pressures from 60 to 150 psi (4.1 to 10.3 bar).

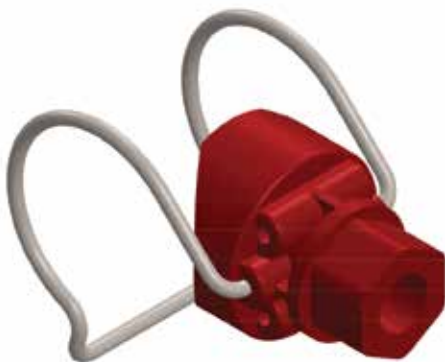

Uni-Spray manufactures all its high-quality spray systems in Canada. These products are available globally and distributed in 65 countries.

Mark 2 Fixed Nozzle Adapter ORDERING INSTRUCTIONS

How to order a Mark 2 Fixed Nozzle Adapter:

The complete Part Number tells us exactly what assembly you want.

For example, let's say that you want to order a Mark 2 Fixed Nozzle Adapter to fit onto a 1 1/4" pipe, with Double Springs for high pressure, and a 1/4" NPT female threaded connection for use with your standard threaded nozzle tips:

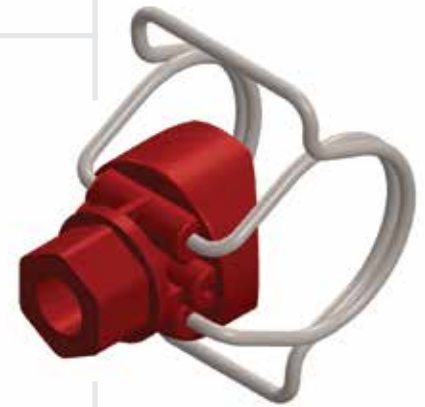

STEP 1

The Part Number begins with UNI, followed by the pipe:

- UNI 100 = 1" pipe
- UNI 125 = 1 1/4" pipe
- UNI 150 = 1 1/2" pipe
- UNI 200 = 2" pipe

So in our example, we would have so far

UNI 125

STEP 2

The Thread Sizes are shown as follows:

- 18 N = 1/8" NPT
- 18 B = 1/8" NPT
- 14 N = 1/4" NPT
- 38 N = 3/8" NPT
- 12 N = 1/2" NPT

In our example we now have

UNI 125 14 N

STEP 3

Add M2 D to denote the Style, where D stands for Double Spring. If you wanted a Single Spring, the Style would be M2 S.

So in our example, we end up with

UNI 125 14 N M2 D